

23 MAY 2025  
19.00–22.00

# MEMBERS NIGHT

AT TATE MODERN

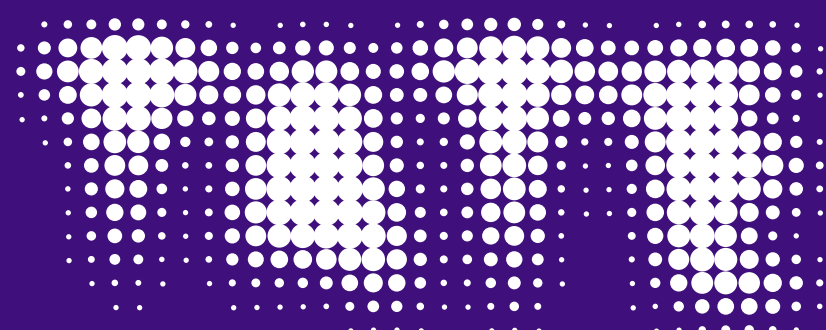

# LEVEL 0

## WORKSHOPS TALKS AND TOURS

Creative Play Session  
with Colour Club London  
19.00–22.00\*  
Turbine Hall

\* Last entry 21.30

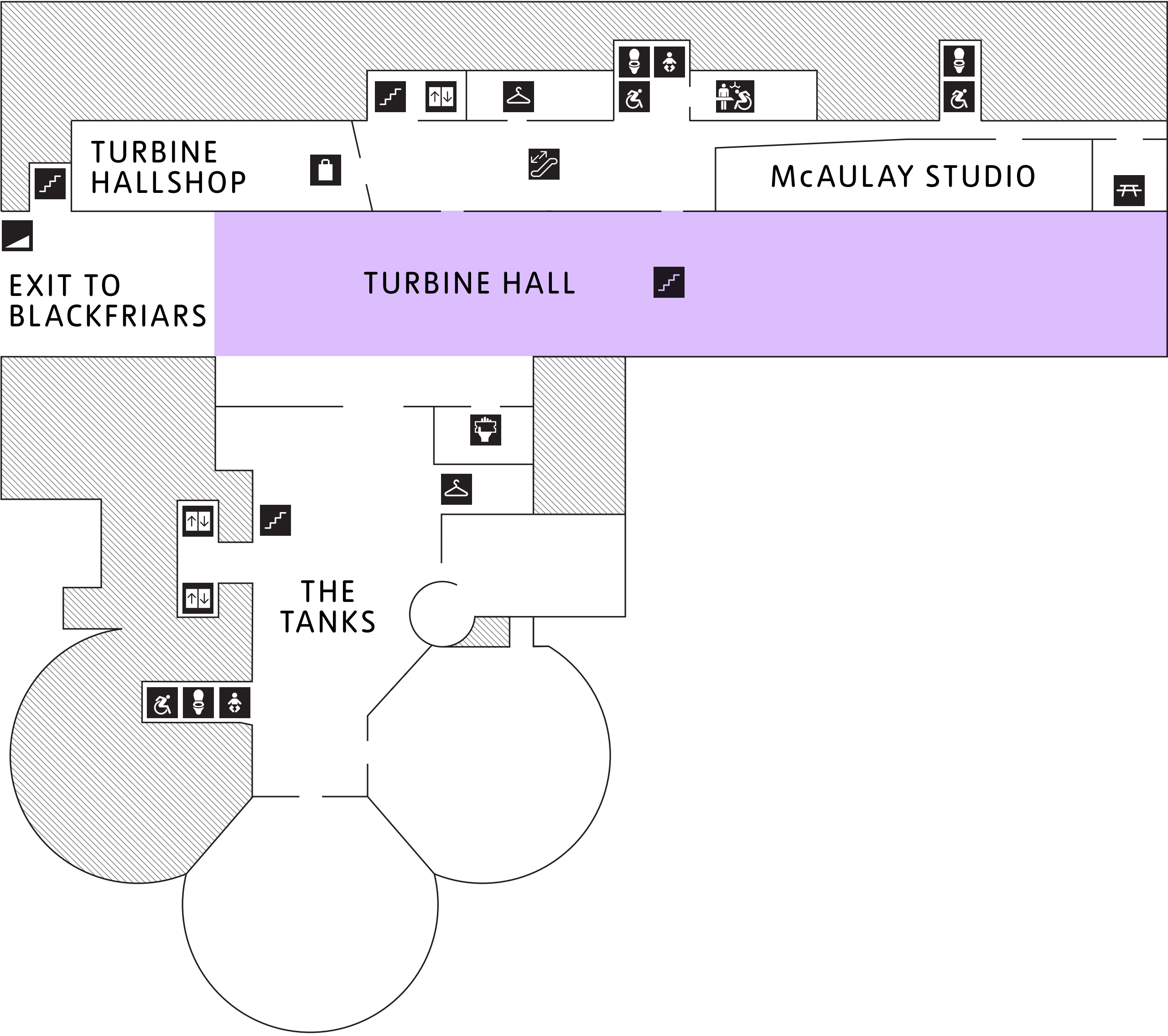

### KEY

- |                    |           |                 |
|--------------------|-----------|-----------------|
| Toilets            | Shop      | Stairs          |
| Accessible toilets | Cloakroom | Escalator       |
| Baby changing      | Lift      | Accessible ramp |
| Tickets            |           |                 |

# LEVEL 1



## FOOD & DRINK

**Members Bar**  
Last orders at 21.30

**20 Minute Tipples**  
19.00 MOMO Kombucha  
19.45 Hundred Hills  
English Wines  
20.30 Oliver’s Fine Cider  
(pre-booking required)

## MUSIC

**L1 Bridge**  
Live music sets  
19.00–20.00  
and 20.30–21.30

**Corner**  
DJ sets with Peter Adjaye  
18.00–23.00

## WORKSHOPS, TALKS AND TOURS

**Book Signing: Yinka Ilori**  
20.00–21.00  
Terrace Shop

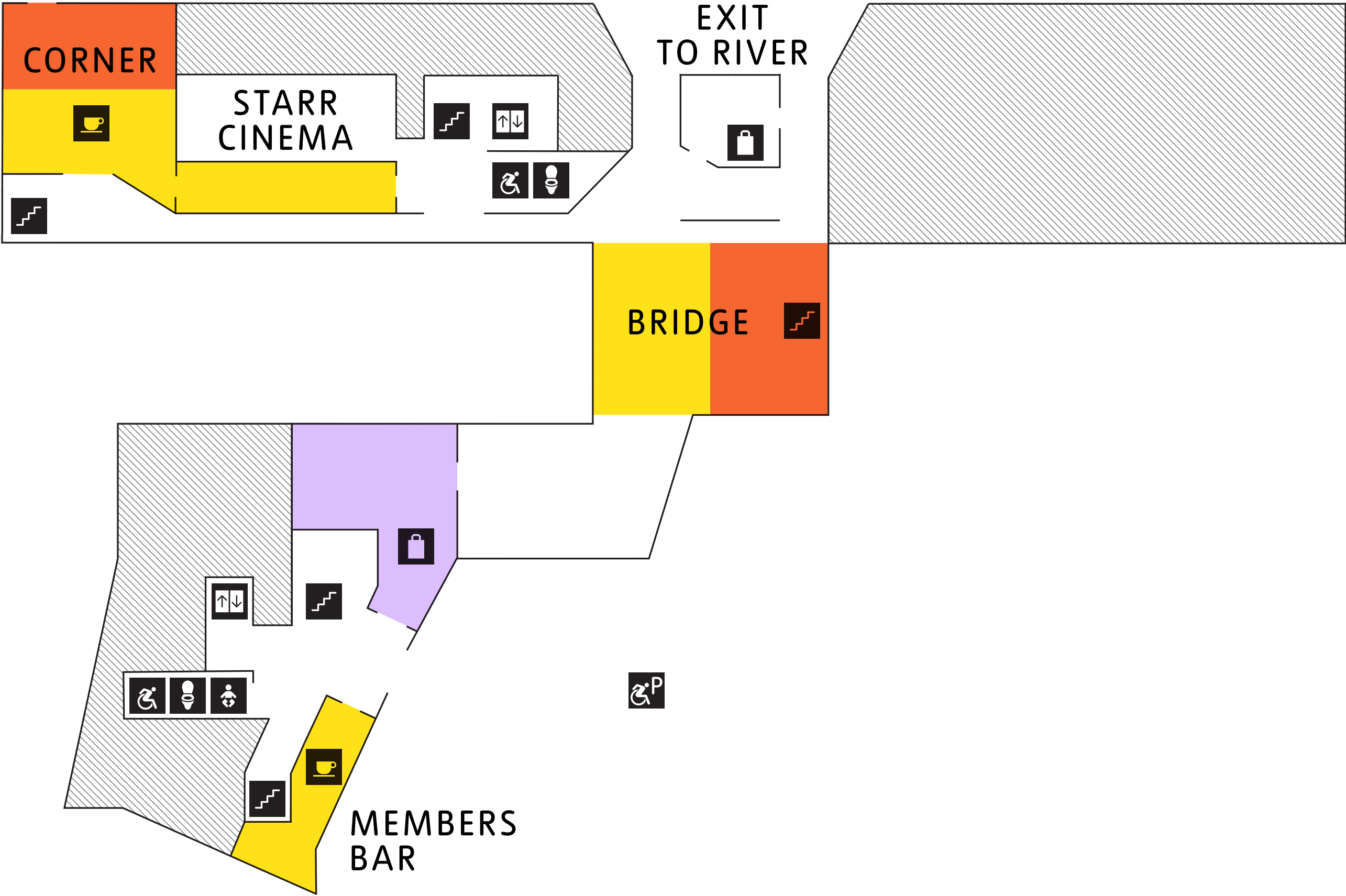

### KEY

- |                    |      |        |
|--------------------|------|--------|
| Toilets            | Shop | Café   |
| Accessible toilets | Lift | Stairs |
| Baby changing      |      |        |

# LEVEL 2

## EXHIBITIONS

Do Ho Suh

## WORKSHOPS, TALKS AND TOURS

Tours of the permanent collection  
See on-site signage or ask a member of staff about our tour schedule  
Natalie Bell Building

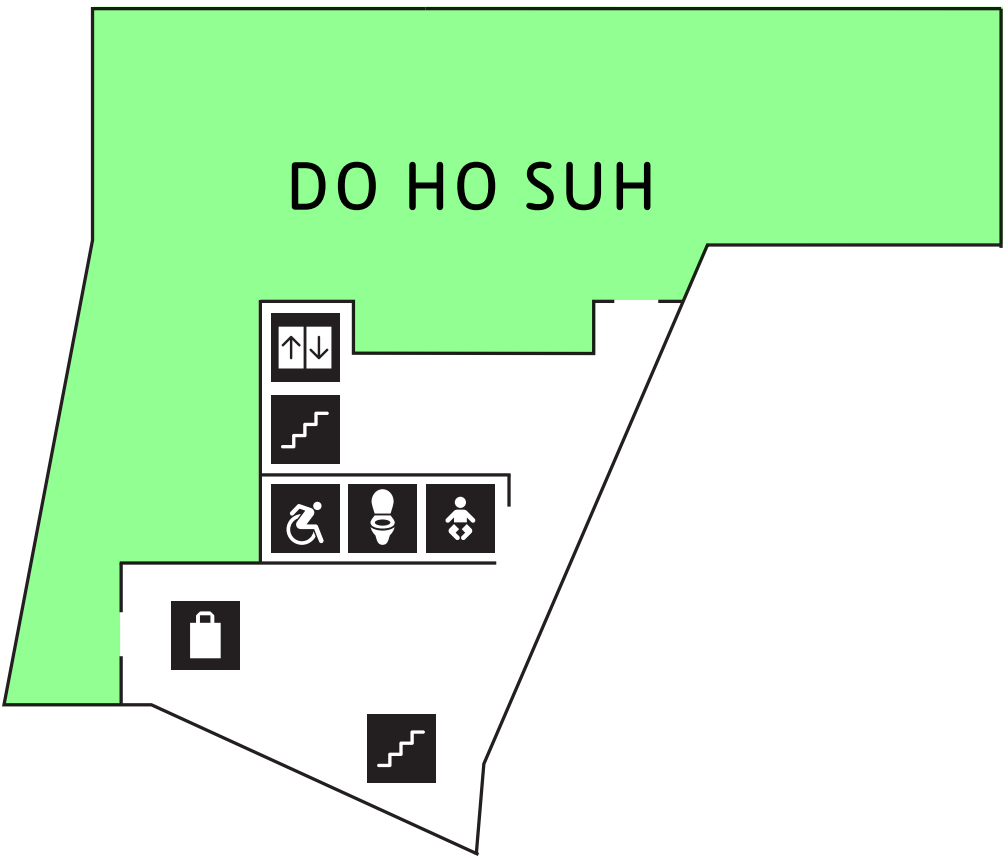
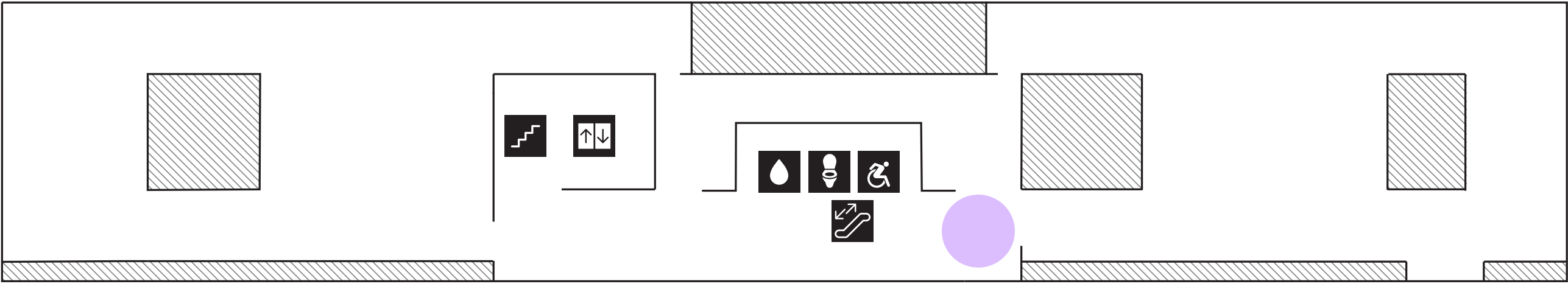

### KEY

- |                    |        |                   |
|--------------------|--------|-------------------|
| Toilets            | Shop   | Escalator         |
| Accessible toilets | Lift   | Drinking fountain |
| Baby changing      | Stairs |                   |

# LEVEL 3



## EXHIBITIONS

Electric Dreams  
  
Leigh Bowery

## FOOD & DRINK

Espresso Bar  
Last orders at 21.30

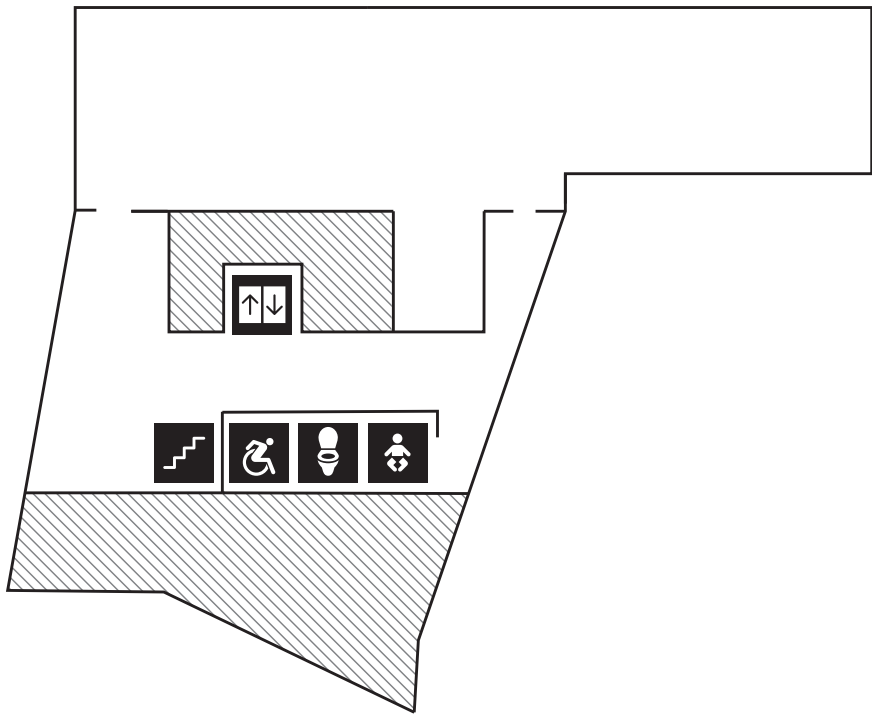
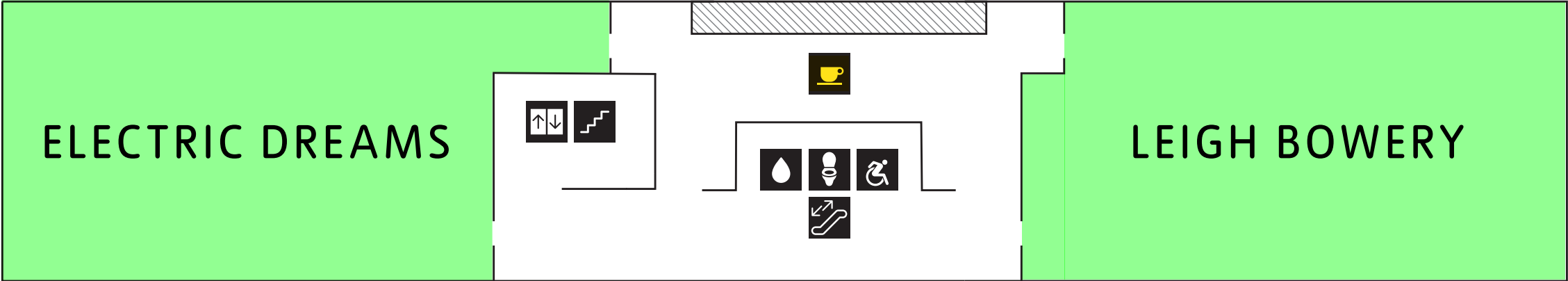

### KEY

- |                    |                   |           |
|--------------------|-------------------|-----------|
| Toilets            | Café              |           |
| Accessible toilets | Drinking fountain | Stairs    |
| Baby changing      | Lift              | Escalator |

# LEVEL 4, 5, 6 & 10

EXHIBITIONS  
LEVEL 4

Anthony McCall

FOOD & DRINK  
LEVEL 5

Members Bar  
Last orders at 21.30

LEVEL 6

Restaurant  
Dinner with live jazz  
(pre-booking recommended)  
Drop-in bar  
Last orders at 22.30

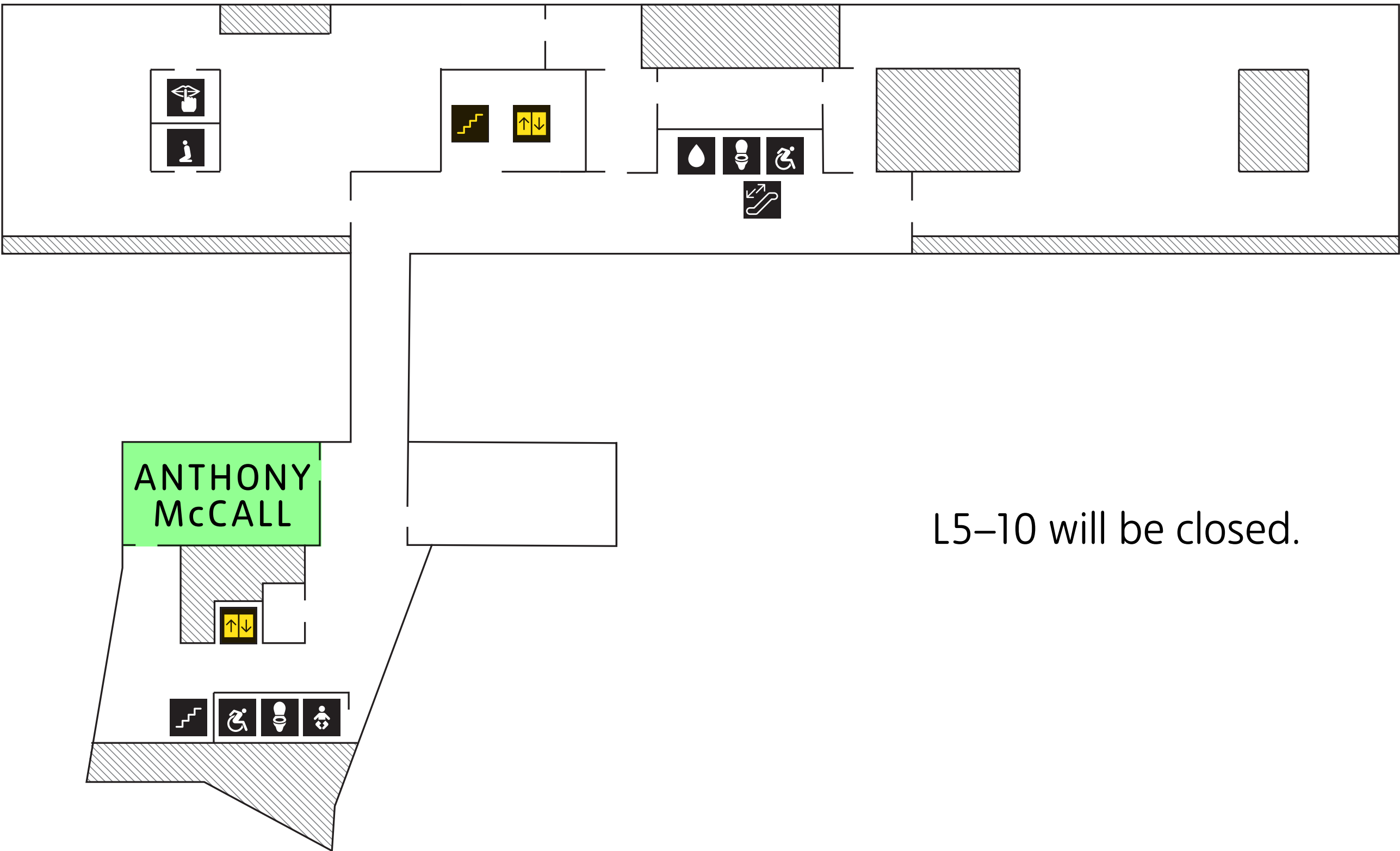

## KEY

- |                    |           |                                    |
|--------------------|-----------|------------------------------------|
| Toilets            | Stairs    | Quiet room                         |
| Accessible toilets | Escalator | Multi-faith and Contemplation room |
| Baby changing      | Lift      |                                    |
| Drinking fountain  |           |                                    |

FOR DETAILED EVENTS INFORMATION GO TO:  
[tate.org.uk/whats-on/tate-modern/members-night](https://tate.org.uk/whats-on/tate-modern/members-night)